

Delock GSM UMTS LTE Antenna SMA Plug 2.5 dBi 2 m RG-174 omnidirectional adhesive mounting

Description

This GSM UMTS LTE antenna by Delock allows the use of different frequency bands indoors. It is completely ZigBee 868 / 915 MHz, DECT and Z-Wave compatible.



2 m

Item no. 89494

EAN: 4043619894949

Country of origin: China

Package: Zip poly bag

Technical details

- Connector: SMA plug
- LTE Band: 1-6/8-10/19/25/33-37/39
- Frequency range: 824 - 960, 1920 - 2170 Mhz
- GSM, UMTS, ZigBee 868 / 915 MHz, DECT, Z-Wave
- Antenna gain: 2.5 dBi
- Impedance: 50 Ohm
- Polarisation: vertical
- VSWR: 2.0
- Operating temperature: -40 °C ~ 85 °C
- Colour: black
- Dimensions (LxWxH): ca. 126.0 x 16.2 x 8.8 mm
- Cable category: coaxial
- Cable type: RG-174
- Cable colour: black
- Cable attenuation: 1,8 dB @ 1.8 GHz per meter
- Cable diameter: ca. 2.7 mm
- Cable length incl. connector: ca. 2 m

System requirements

- Device with free SMA connector

Package content

- GSM UMTS LTE antenna

Images

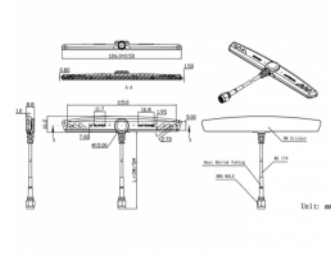

General

| | |
|-----------------------|---------------|
| Mounting type: | Self adhesive |
| Suitable for indoor: | yes |
| Suitable for outdoor: | no |

Interface

| | |
|------------|---------|
| connector: | 1 x SMA |
|------------|---------|

Technical characteristics

| | |
|------------------------|--|
| Frequency range: | 824 MHz - 960 MHz 1710 MHz - 2170 MHz |
| Antenna gain: | 2.5 dBi |
| Impedance: | 50 Ω |
| Operating temperature: | -40 °C ~ 85 °C |
| Polarisation: | linear vertical |
| VSWR: | 2.0 |

Physical characteristics

| | |
|-------------------------------|-----------------------------------|
| Housing colour: | black |
| Housing material: | ABS |
| Cable category: | coaxial |
| Cable type: | RG-174 |
| Cable attenuation: | 1.5 dB @ 1.5 GHz per meter RG-174 |
| Cable colour: | black |
| Cable length incl. connector: | 2 m |
| Length: | 126 mm |
| Width: | 16.2 mm |
| Height: | 8.8 mm |

Colour:

black

