

Delock Converter SATA pin 8 power receptacle > M.2 Key B slot

Description

This converter by Delock enables the connection of a M.2 SSD in 2280, 2260, 2242 and 2230 format. The converter can be connected to a SATA pin 8 power plug and does not need an additional power supply. Additionally, the converter can be connected to a standard SATA port, then a power supply to the 4 pin power connector is needed.

[63917 Video](#)

Note

If the converter is connected to a SATA pin 8 power port, a few SSDs will not get enough power. In that case a power supply needs to be connected to the 4 pin power plug.

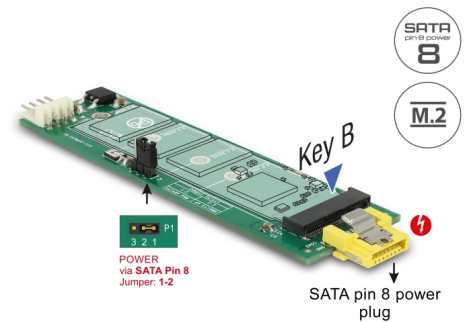

Item no. 63917

EAN: 4043619639175

Country of origin: China

Package: Retail Box

Technical details

- Connectors:
 - 1 x SATA 6 Gb/s receptacle pin 8 power with latchtype >
 - 1 x 67 pin M.2 key B slot
 - 1 x Floppy 4 pin power plug (power supply for standard SATA ports)
- Interface: SATA
- Supports M.2 modules in format 2280, 2260, 2242 and 2230 with key B or key B+M based on SATA
- Maximum height of the components on the module: 1.5 mm, application of double-sided assembled modules supported
- LEDs for power and activity
- Jumper to set the power supply
- Data transfer rate up to 6 Gb/s
- Dimensions (LxWxH): ca. 114 x 30 x 11 mm

System requirements

- Linux Kernel 3.10 or above
- Windows 7/7-64/8.1/8.1-64/10/10-64
- One free SATA pin 8 power plug or
- One free SATA port + 4 pin power connector

Package content

- Converter
- Power cable 4 pin to SATA, length ca. 10 cm
- User manual

Images

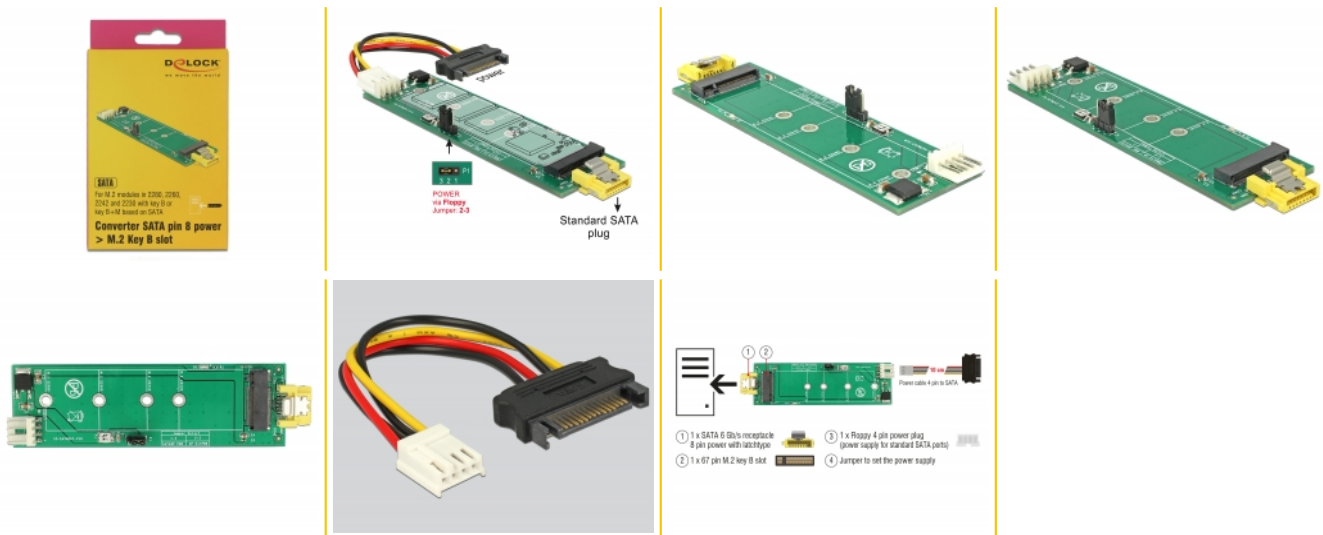

General

Supported operating system:	Linux Kernel 3.10 or above Windows 10 32-Bit Windows 10 64-Bit Windows 7 32-Bit Windows 7 64-Bit Windows 8.1 32-Bit Windows 8.1 64-Bit
Slot:	SATA
Maximum height of the components on the module:	1.5 mm application of double-sided assembled modules supported

Interface

Connector 1:	1 x SATA 6 Gb/s receptacle pin 8 power with latchtype
Connector 2:	1 x 67 pin M.2 key B slot
connector 3:	1 x Floppy 4 pin power plug

Technical characteristics

Data transfer rate:	6 Gb/s
---------------------	--------

Physical characteristics

Length:	114 mm
Width:	30 mm
Height:	11 m