

Recommended Panel Cutout

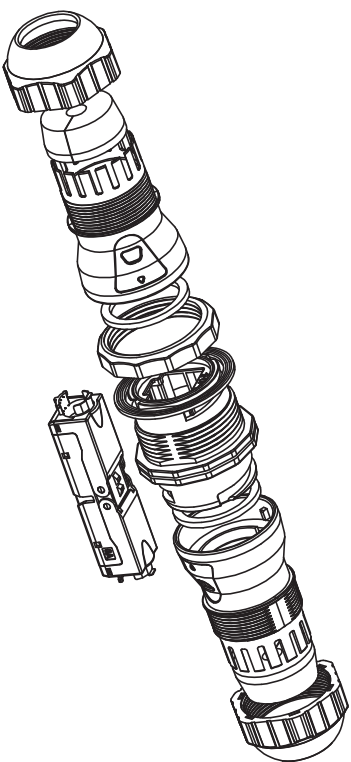
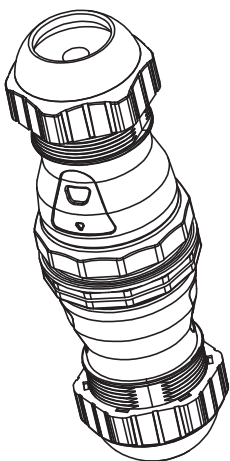
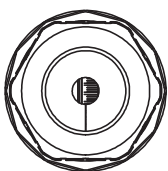
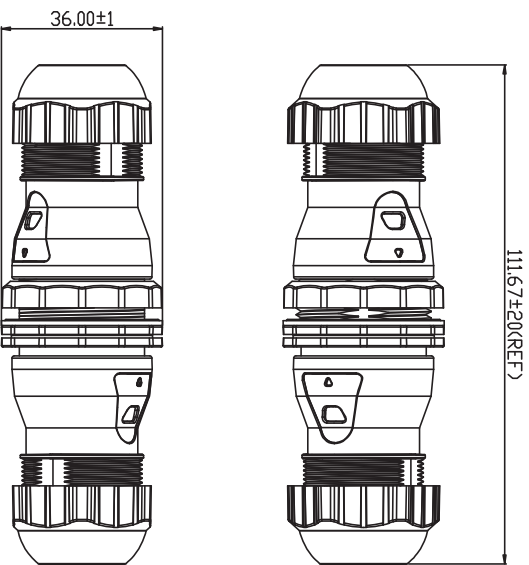

**ELECTRICAL:**

Current rating : 1.5A

Dielectric withstanding voltage : 1000V/AC 60Hz

Insulation resistance : 500 MΩ MIN.

Contact resistance : 20 mΩ MAX.

**MECHANICAL:**

Supporting Cable Diameter: 4~6mm

Operating Temperature:-10°C to +60°C

Storage Temperature:-40°C to +70°C

MEETS IP68 STANDARD

**MATERIAL:**

Housing: PA66

Seal Ring: SILICONE RUBBER

Connecting Coupler:

Housing: Zinc-alloy ,Nickel Plated

IDC Terminals: Phosphor Bronze,Tin Plated

Pinout: T1A-568A/8

<b>DLOCK®</b> we move the world			
Title: Cable connector LSA to LSA Cat.6A IP68 dust and waterproof black			
Dat	2024 / 05 / 21	Item no.	67045
Unit	mm	Barcode	4043619670451
Projection		File No.	88467
Rev	A		