

1

2

3

4

5

6

A

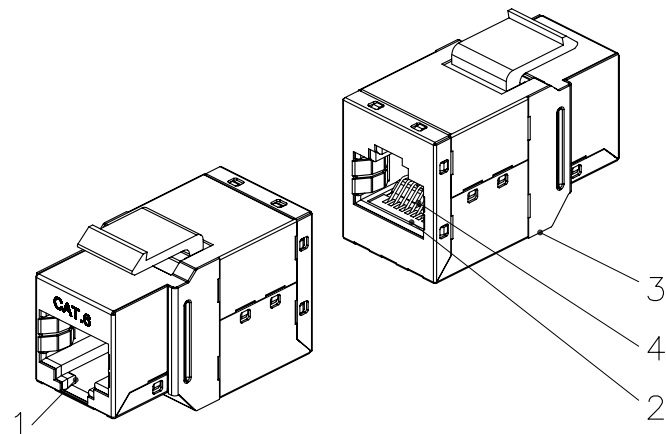

SCALE 1/1

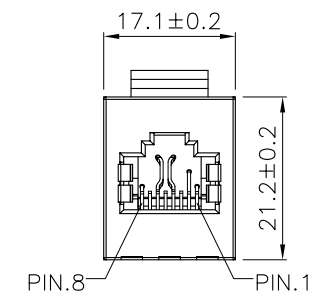
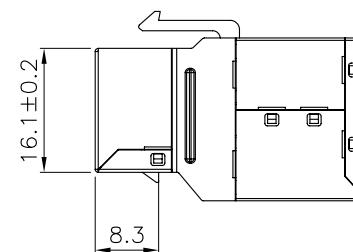
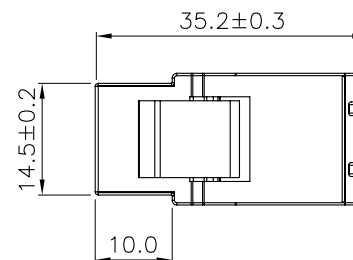
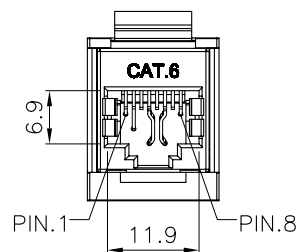

B

B

C

C

Specification :

Material :

1. RJ45 Jack Housing : ABS+PC, UL 94V-0, Black color.
2. RJ45 Jack Bracket Set : PC, UL 94V-2, Transparent color.
3. RJ45 Jack Shield : Bronze, Nickel plated.
4. RJ45 Jack Contact :
 - 4-1. Material : Phosphor Bronze with Nickel plated.
 - 4-2. Finish : 50 micro-inch Gold plated on Plug contact area.
5. PCB : FR4, UL 94V-0.

Performance :

- a. Insertion force : 30N max. (IEC 60603-7-5).
- b. Retention strength : 7.7 kg between Jack and Plug.
- c. Operating temperature : -10°C to 60°C. (ISO/IEC 11801, ANSI/TIA/EIA 568 B.2)
- d. Life(mating cycles) : 750 cycles min. (ISO/IEC 11801, IEC 60603-7-5).
- e. The Cat.6 transmission performance is in compliance with the ANSI/TIA/EIA 568 B.2-1 standard.

D

GENERAL TOLERANCE OF DIMENSIONS ±0.1	DRAWING				DELOCK® we move the world	
	CHECK					
	APPROVAL					
			DATE	NAME	ITEM NO.:	
	SCALE	(A4)	UNIT			
			DRAWING NO.			
DRAWING CLASSIFICATION						

1

2

0

3

4

10cm

5